



“ATTENTION”

This Mounted Resistance is exclusive to the model Super Ducha 3T Fame (3 temperatures). Not used for other types of Duchas.

“SUPER FITTING SYSTEM”

See how easy is to change the element.

It is not necessary to remove the Super Ducha from the hydraulic connection.



Important for your safety

Before starting the replacement of the element, **switch off the main electrical switch** or the insulating switch of the electrical circuit of the Super Ducha 3T.

Close the stop-tap of the pipe where the device is installed.

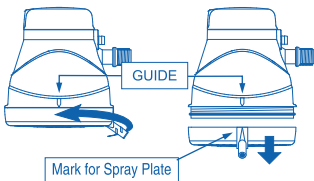
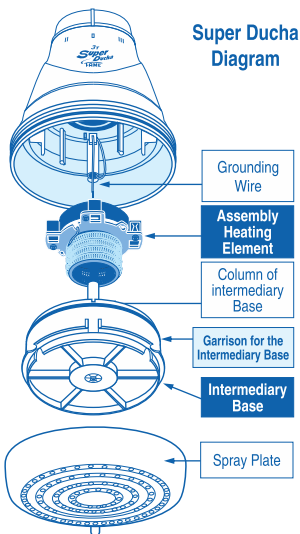

Hold firmly the Super Ducha head and remove the spray plate rotating it to the anti-clockwise direction: Until the mark of Spray Plate be aligned with the Guide.

Observe on the picture, that in the remotion moment, water will come out with the spray plate.

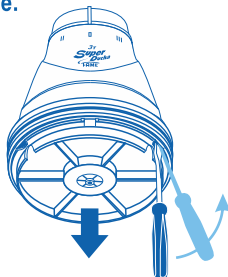

It is necessary remove the intermediary Base to access the element;

To do this use acrewdriver between the bown and the Intermediary Base to have access by one of five openings and do a pull moviment. In this operation the Intermediary Base come off with water.

In case of the Garrison remains fixed on the bown, with a screwdriver release it. (Picture1) and place it into the dorm area of the Intermediary Base (Picture2).

Picture 1: Releasing the Garrison from the bowl.

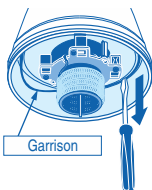

Picture 2: Placing the Garrison on the Intermediary Base.

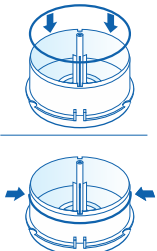

Pull and remove the assembly heating element observing the fitting position.

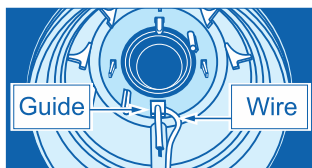
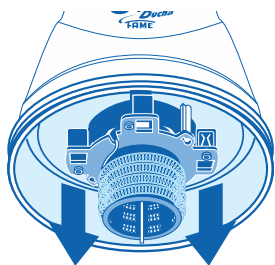

Before fit the new element certify that the Wire is correctly fitting into your Guide.

Fit the new heating element on the three contacts, being guided by the Guide Pin.

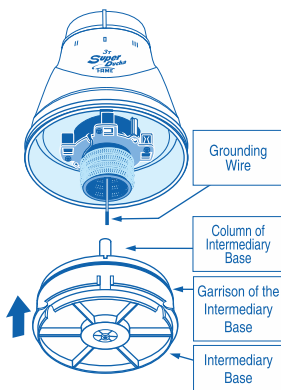
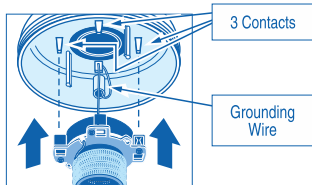
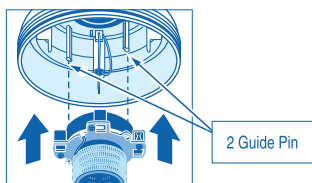

Before to fix the Intermediary Base, certify that the Grounding Wire be inside of the column of the Intermediary Base and your Garrison be fixed correctly. The fixing only be done for the guides of the bowl and Intermediary Base.

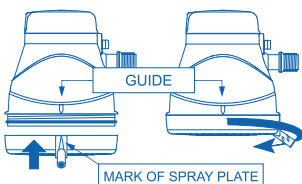

Twisting the spray plate clockwise only by hand, leading through the spray plate's mark aligned with the guide of chamber; Rotate it until the proper tightening, only 1/4" turn.

Finally to avoid damages to heating element, open the stop-tap a few seconds, in order to fill the heating chamber and only after this turn on the insulating switch.

Remember, changing the position of temperature selector, close the stop valve before.

If you have a doubt or an opinion on our products please contact our customer service:

Tel: 55 11 3478-5618 - Fax: 55 11 3478-5695
 email: exporta@fame.com.br
www.fame.com.br