

# ELECTRIC WATER HEATER



## INSTRUCTION TO REPLACE THE HEATING ELEMENT

SEE HOW EASY IS TO CHANGE THE ELEMENT.

IT IS NOT NECESSARY TO REMOVE THE HEATER FROM THE HYDRAULIC CONNECTION.

Note: If It is not possible to follow the below instructions, for this way of installation, **remove** the heater from the hydraulic connection.

Before starting the replacement of the element, switch off the main electrical switch or the insulating switch of the electrical circuit of the heater. Close the tap-valve of the hydraulic connection where the device is installed. **Place a recipient under the heater to take the accumulated water into the heating chamber and in the flexible connector.**

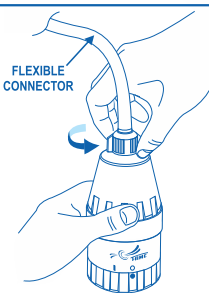

1 - Unscrew the nut from the flexilble connector of the outlet water of the heating chamber.

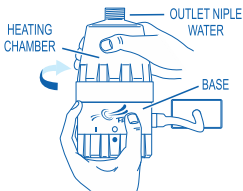

2 - Unscrew the heating chamber with the hands and separate the base, to access the element. Observe as the element is fixed with two screw to the contacts , for that you can return it to the same position.

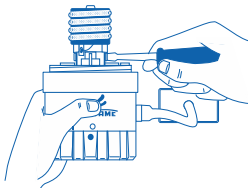

3 - Release the two screw that are fixing the element with the screwdriver and remove them . Clean the electric contact areas and place the new element at the same position, fullytighting the screws.

4 - Set back the heating chamber on the base screwing with the hands.

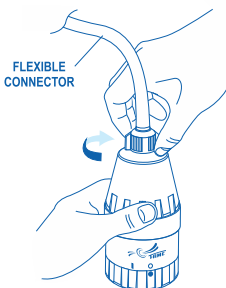

5 - Set back the nut of the flexible connector to the outlet water of the heating chamber. If it is necessary use a tool to complete the final fixing. Take attention to use the gasket to sealing.

6 - Open the water tap in order to fill the heating chamber to avoid damage to the element.  
After the hydraulic test reconnect the electric circuit and it is ready to be used normally.

### ATTENTION

The element fixation **with screws**, is technique imposition that afford perfect electric contact ensuring the product durability .