

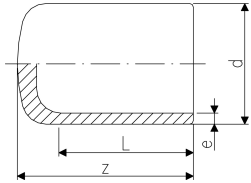

ELGEF Plus End cap PE100
d20-d630mm / SDR11 / Long version

- 10 bar Gas / 16 bar Water
- * FM 1613 approved - 15 bar
- ** FM 1613 approved - 12 bar
- *** Fabricated fitting made from pipe



| | d (mm) | SDR | PN (bar) | DN (mm) | Code | Weight (kg) | z (mm) | L (mm) | e (mm) |
|----------|------------------|------------|--------------------|-------------------|--------------------|-----------------------|------------------|------------------|------------------|
| | 20 | 11 | 16 | 15 | 753 961 006 | 0.010 | 52 | 52 | 3.0 |
| | 25 | 11 | 16 | 20 | 753 961 007 | 0.015 | 52 | 52 | 3.0 |
| | 32 | 11 | 16 | 25 | 753 961 008 | 0.020 | 54 | 54 | 3.0 |
| | 40 | 11 | 16 | 32 | 753 961 009 | 0.033 | 57 | 57 | 3.7 |
| | 50 | 11 | 16 | 40 | 753 961 010 | 0.054 | 63 | 63 | 4.6 |
| | 63 | 11 | 16 | 50 | 753 961 011 | 0.086 | 65 | 65 | 5.8 |
| | 75 | 11 | 16 | 65 | 753 961 012 | 0.146 | 80 | 72 | 6.8 |
| * | 90 | 11 | 16 | 80 | 753 961 013 | 0.240 | 90 | 81 | 8.2 |
| * | 110 | 11 | 16 | 100 | 753 961 014 | 0.373 | 98 | 86 | 10.0 |
| * | 125 | 11 | 16 | 100 | 753 961 015 | 0.546 | 105 | 92 | 11.4 |
| * | 140 | 11 | 16 | 125 | 753 961 016 | 0.727 | 136 | 92 | 12.7 |
| * | 160 | 11 | 16 | 150 | 753 961 017 | 1.034 | 120 | 102 | 14.6 |
| * | 180 | 11 | 16 | 150 | 753 961 018 | 1.351 | 128 | 107 | 16.4 |
| * | 200 | 11 | 16 | 200 | 753 961 019 | 1.845 | 138 | 115 | 18.2 |
| * | 225 | 11 | 16 | 200 | 753 961 020 | 2.514 | 148 | 122 | 20.5 |
| * | 250 | 11 | 16 | 250 | 753 961 021 | 3.927 | 205 | 130 | 22.7 |
| * | 280 | 11 | 16 | 250 | 753 960 922 | 5.045 | 235 | 139 | 25.4 |
| * | 315 | 11 | 16 | 300 | 753 960 923 | 6.861 | 255 | 150 | 28.6 |
| ** , *** | 355 | 11 | 16 | 350 | 753 960 924 | 9.780 | 280 | 165 | 32.3 |
| ** , *** | 400 | 11 | 16 | 400 | 753 960 925 | 13.370 | 310 | 180 | 36.4 |
| ** , *** | 450 | 11 | 16 | 450 | 753 960 926 | 22.120 | 300 | 220 | 40.9 |
| ** , *** | 500 | 11 | 16 | 500 | 753 960 927 | 30.226 | 325 | 240 | 45.4 |
| *** | 560 | 11 | 16 | 600 | 753 960 928 | 42.368 | 360 | 270 | 50.8 |
| *** | 630 | 11 | 16 | 600 | 753 960 929 | 64.850 | 400 | 300 | 54.2 |

The technical data are not binding. They neither constitute expressly warranted characteristics nor guaranteed properties nor a guaranteed durability. They are subject to modification. Our General Terms of Sale apply.

Georg Fischer Piping Systems Ltd, Postfach, CH-8201 Schaffhausen/Switzerland

Phone +41 -(0)52-631 1111

e-mail: info.ps@georgfischer.com

Internet: <http://www.gfps.com>