

**ecoFIT Reducer PE100**  
d25-710mm / SDR11

**Model:**

- Conventional butt-welding according to DVS 2207
- IR = Infrared-(IR Plus) compatible. Choose fusion parameters: PE100
- Up to d 315 injection moulded, above machined

| d<br>(mm) | d1<br>(mm) | DN<br>(mm) | PN<br>(bar) | SDR | FM | Code        | Weight<br>(kg) | PF           |
|-----------|------------|------------|-------------|-----|----|-------------|----------------|--------------|
| 25        | 20         | 20         | 16          | 11  | IR | 753 908 637 | 0.008          | 2 68 240 011 |
| 32        | 20         | 25         | 16          | 11  | IR | 753 908 642 | 0.010          | 2 68 240 011 |
| 32        | 25         | 25         | 16          | 11  | IR | 753 908 641 | 0.006          | 2 68 240 011 |
| 40        | 20         | 32         | 16          | 11  | IR | 753 908 648 | 0.017          | 2 68 240 011 |
| 40        | 25         | 32         | 16          | 11  | IR | 753 908 647 | 0.017          | 2 68 240 011 |
| 40        | 32         | 32         | 16          | 11  | IR | 753 908 646 | 0.019          | 2 68 240 011 |
| 50        | 25         | 40         | 16          | 11  | IR | 753 908 654 | 0.025          | 2 68 240 011 |
| 50        | 32         | 40         | 16          | 11  | IR | 753 908 653 | 0.026          | 2 68 240 011 |
| 50        | 40         | 40         | 16          | 11  | IR | 753 908 652 | 0.032          | 2 68 240 011 |
| 63        | 32         | 50         | 16          | 11  | IR | 753 908 660 | 0.046          | 2 68 240 011 |
| 63        | 40         | 50         | 16          | 11  | IR | 753 908 659 | 0.051          | 2 68 240 011 |
| 63        | 50         | 50         | 16          | 11  | IR | 753 908 658 | 0.056          | 2 68 240 011 |
| 75        | 40         | 65         | 16          | 11  | IR | 753 908 666 | 0.070          | 2 68 240 011 |
| 75        | 50         | 65         | 16          | 11  | IR | 753 908 665 | 0.074          | 2 68 240 011 |
| 75        | 63         | 65         | 16          | 11  | IR | 753 908 664 | 0.081          | 2 68 240 011 |
| 90        | 63         | 80         | 16          | 11  | IR | 753 908 671 | 0.125          | 2 68 240 011 |
| 90        | 75         | 80         | 16          | 11  | IR | 753 908 670 | 0.132          | 2 68 240 011 |
| 110       | 63         | 100        | 16          | 11  | IR | 753 908 672 | 0.219          | 2 68 240 011 |
| 110       | 75         | 100        | 16          | 11  | IR | 753 908 677 | 0.219          | 2 68 240 011 |
| 110       | 90         | 100        | 16          | 11  | IR | 753 908 676 | 0.240          | 2 68 240 011 |
| 125       | 110        | 100        | 16          | 11  | IR | 753 908 680 | 0.350          | 2 68 240 005 |
| 140       | 110        | 125        | 16          | 11  | IR | 753 908 685 | 0.437          | 2 68 240 005 |
| 140       | 125        | 125        | 16          | 11  | IR | 753 908 684 | 0.474          | 2 68 240 005 |
| 160       | 110        | 150        | 16          | 11  | IR | 753 908 690 | 0.612          | 2 68 240 005 |
| 160       | 140        | 150        | 16          | 11  | IR | 753 908 688 | 0.674          | 2 68 240 005 |
| 180       | 90         | 150        | 16          | 11  | IR | 753 908 149 | 0.925          | 2 68 240 011 |
| 180       | 110        | 150        | 16          | 11  | IR | 753 908 150 | 1.020          | 2 68 240 011 |
| 180       | 125        | 150        | 16          | 11  | IR | 753 908 151 | 1.020          | 2 68 240 011 |
| 180       | 140        | 150        | 16          | 11  | IR | 753 908 152 | 1.015          | 2 68 240 011 |
| 180       | 160        | 150        | 16          | 11  | IR | 753 908 153 | 1.140          | 2 68 240 011 |
| 200       | 160        | 200        | 16          | 11  | IR | 753 908 692 | 1.247          | 2 68 240 005 |
| 200       | 180        | 200        | 16          | 11  | IR | 753 908 158 | 1.475          | 2 68 240 011 |
| 225       | 110        | 200        | 16          | 11  | IR | 753 908 695 | 1.559          | 2 68 240 005 |
| 225       | 160        | 200        | 16          | 11  | IR | 753 908 696 | 1.590          | 2 68 240 005 |
| 225       | 180        | 200        | 16          | 11  | IR | 753 908 162 | 1.800          | 2 68 240 011 |
| 225       | 200        | 200        | 16          | 11  | IR | 753 908 697 | 1.844          | 2 68 240 005 |
| 250       | 160        | 250        | 16          | 11  | IR | 753 908 165 | 2.305          | 2 68 240 011 |
| 250       | 180        | 250        | 16          | 11  |    | 753 900 001 | 2.513          | 2 68 240 040 |
| 250       | 200        | 250        | 16          | 11  |    | 753 900 002 | 2.450          | 2 68 240 040 |
| 250       | 225        | 250        | 16          | 11  |    | 753 908 168 | 3.025          | 2 68 240 011 |
| 280       | 200        | 250        | 16          | 11  |    | 753 900 004 | 3.540          | 2 68 240 040 |
| 280       | 225        | 250        | 16          | 11  |    | 753 908 172 | 3.860          | 2 68 240 011 |
| 280       | 250        | 250        | 16          | 11  |    | 753 908 173 | 4.155          | 2 68 240 011 |
| 315       | 200        | 300        | 16          | 11  |    | 753 900 007 | 3.996          | 2 68 240 040 |
| 315       | 225        | 300        | 16          | 11  |    | 753 908 176 | 5.260          | 2 68 240 011 |
| 315       | 250        | 300        | 16          | 11  |    | 753 908 177 | 5.415          | 2 68 240 011 |
| 315       | 280        | 300        | 16          | 11  |    | 753 908 178 | 5.600          | 2 68 240 011 |
| 355       | 225        |            |             |     |    | 753 900 011 | 4.700          | 2 68 240 040 |
| 355       | 250        |            |             |     |    | 753 900 012 | 4.400          | 2 68 240 040 |
| 355       | 280        |            |             |     |    | 753 900 013 | 4.100          | 2 68 240 040 |
| 355       | 315        |            |             |     |    | 753 900 014 | 3.700          | 2 68 240 040 |

# Data sheet

valid from: 9/14/21

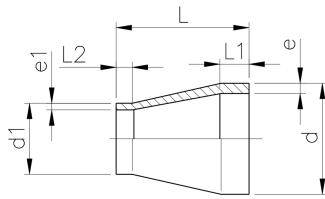

| d<br>(mm) | d1<br>(mm) | DN<br>(mm) | PN<br>(bar) | SDR | FM | Code        | Weight<br>(kg) | PF           |
|-----------|------------|------------|-------------|-----|----|-------------|----------------|--------------|
| 400       | 225        |            |             |     |    | 753 900 015 | 7.963          | 2 68 240 040 |
| 400       | 280        |            |             |     |    | 753 900 017 | 6.200          | 2 68 240 040 |
| 400       | 315        |            |             |     |    | 753 900 018 | 10.829         | 2 68 240 040 |
| 400       | 355        |            |             |     |    | 753 900 019 | 4.800          | 2 68 240 040 |
| 450       | 280        |            |             |     |    | 753 900 020 | 9.000          | 2 68 240 040 |
| 450       | 315        |            |             |     |    | 753 900 021 | 8.000          | 2 68 240 040 |
| 450       | 355        |            |             |     |    | 753 900 022 | 7.400          | 2 68 240 040 |
| 450       | 400        |            |             |     |    | 753 900 023 | 6.600          | 2 68 240 040 |
| 500       | 355        |            |             |     |    | 753 900 025 | 10.800         | 2 68 240 040 |
| 500       | 400        |            |             |     |    | 753 900 026 | 10.000         | 2 68 240 040 |
| 500       | 450        |            |             |     |    | 753 900 027 | 8.300          | 2 68 240 040 |
| 710       | 500        |            |             |     |    | 753 900 035 | 24.157         | 2 68 240 040 |
| 710       | 560        |            |             |     |    | 753 900 036 | 21.770         | 2 68 240 040 |
| 710       | 630        |            |             |     |    | 753 900 037 | 17.845         | 2 68 240 040 |

| d<br>(mm) | d1<br>(mm) | L<br>(mm) | L1<br>(mm) | L2<br>(mm) | e<br>(mm) | e1<br>(mm) |
|-----------|------------|-----------|------------|------------|-----------|------------|
| 25        | 20         | 50        | 20         | 18         | 2.3       | 1,9        |
| 32        | 20         | 50        | 20         | 18         | 2.9       | 1,9        |
| 32        | 25         | 50        | 20         | 18         | 2.9       | 2,3        |
| 40        | 20         | 58        | 20         | 20         | 3.7       | 1,9        |
| 40        | 25         | 55        | 20         | 18         | 3.7       | 2,3        |
| 40        | 32         | 55        | 20         | 18         | 3.7       | 2,9        |
| 50        | 25         | 60        | 20         | 18         | 4.6       | 2,3        |
| 50        | 32         | 60        | 20         | 18         | 4.6       | 2,9        |
| 50        | 40         | 60        | 20         | 18         | 4.6       | 3,7        |
| 63        | 32         | 65        | 20         | 18         | 5.8       | 2,9        |
| 63        | 40         | 65        | 20         | 18         | 5.8       | 3,7        |
| 63        | 50         | 65        | 20         | 18         | 5.8       | 4,6        |
| 75        | 40         | 68        | 20         | 20         | 6.8       | 3,7        |
| 75        | 50         | 65        | 20         | 18         | 6.8       | 4,6        |
| 75        | 63         | 65        | 20         | 18         | 6.8       | 5,8        |
| 90        | 63         | 75        | 21         | 17         | 8.2       | 5,8        |
| 90        | 75         | 75        | 22         | 17         | 8.2       | 6,8        |
| 110       | 63         | 90        | 28         | 28         | 10.6      | 6,2        |
| 110       | 75         | 90        | 28         | 17         | 10.0      | 6,8        |
| 110       | 90         | 90        | 28         | 20         | 10.0      | 8,2        |
| 125       | 110        | 100       | 32         | 26         | 11.4      | 10,0       |
| 140       | 110        | 110       | 35         | 28         | 12.7      | 10,0       |
| 140       | 125        | 110       | 35         | 28         | 12.7      | 11,4       |
| 160       | 110        | 120       | 40         | 25         | 14.6      | 10,0       |
| 160       | 140        | 120       | 40         | 33         | 14.6      | 12,7       |
| 180       | 90         | 145       | 50         | 40         | 16.4      | 8,2        |
| 180       | 110        | 150       | 55         | 42         | 16.4      | 10,0       |
| 180       | 125        | 143       | 52         | 40         | 16.4      | 11,4       |
| 180       | 140        | 135       | 51         | 47         | 16.4      | 12,7       |
| 180       | 160        | 135       | 55         | 52         | 16.4      | 14,6       |
| 200       | 160        | 150       | 50         | 35         | 18.2      | 14,6       |
| 200       | 180        | 145       | 62         | 54         | 18.2      | 16,4       |
| 225       | 110        | 171       | 55         | 45         | 20.5      | 10,0       |
| 225       | 160        | 160       | 55         | 37         | 20.5      | 14,6       |
| 225       | 180        | 160       | 64         | 59         | 22.7      | 20,5       |
| 225       | 200        | 160       | 55         | 48         | 20.5      | 18,2       |
| 250       | 160        | 177       | 65         | 53         | 20.5      | 14,6       |
| 250       | 180        | 175       | 60         | 55         | 22.7      | 16,4       |
| 250       | 200        | 180       | 60         | 60         | 22.7      | 18,2       |
| 250       | 225        | 180       | 65         | 65         | 22.7      | 20,5       |
| 280       | 200        | 205       | 70         | 50         | 25.4      | 18,2       |
| 280       | 225        | 210       | 75         | 58         | 25.4      | 20,5       |

# Data sheet

valid from: 9/14/21

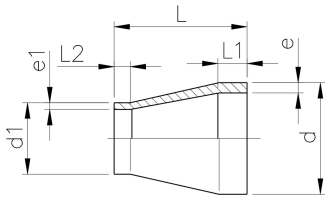

| d    | d1   | L    | L1   | L2   | e    | e1   |
|------|------|------|------|------|------|------|
| (mm) | (mm) | (mm) | (mm) | (mm) | (mm) | (mm) |
| 280  | 250  | 206  | 75   | 60   | 25.4 | 22,7 |
| 315  | 200  | 225  | 80   | 50   | 28.6 | 20,5 |
| 315  | 225  | 237  | 84   | 57   | 28.6 | 20,5 |
| 315  | 250  | 236  | 86   | 64   | 28.6 | 22,7 |
| 315  | 280  | 231  | 86   | 72   | 28.6 | 25,4 |
| 355  | 225  | 245  | 90   | 55   | 32.3 | 20,5 |
| 355  | 250  | 245  | 90   | 60   | 32.3 | 22,7 |
| 355  | 280  | 245  | 90   | 70   | 32.3 | 25,4 |
| 355  | 315  | 245  | 90   | 80   | 32.3 | 28,6 |
| 400  | 225  | 260  | 95   | 60   | 36.4 | 20,5 |
| 400  | 280  | 260  | 95   | 70   | 36.4 | 25,4 |
| 400  | 315  | 260  | 95   | 80   | 36.4 | 28,6 |
| 400  | 355  | 260  | 95   | 90   | 36.4 | 32,3 |
| 450  | 280  | 230  | 60   | 70   | 40.9 | 25,4 |
| 450  | 315  | 230  | 60   | 80   | 40.9 | 28,6 |
| 450  | 355  | 230  | 60   | 90   | 40.9 | 32,3 |
| 450  | 400  | 230  | 60   | 95   | 40.9 | 36,4 |
| 500  | 355  | 230  | 60   | 90   | 45.5 | 32,3 |
| 500  | 400  | 230  | 60   | 95   | 45.5 | 36,4 |
| 500  | 450  | 200  | 60   | 60   | 45.5 | 40,9 |
| 710  | 500  | 190  | 84   | 40   | 64.5 | 45,4 |
| 710  | 560  | 170  | 81   | 40   | 64.5 | 50,8 |
| 710  | 630  | 140  | 71   | 40   | 64.5 | 57,2 |

The technical data are not binding. They neither constitute expressly warranted characteristics nor guaranteed properties nor a guaranteed durability. They are subject to modification. Our General Terms of Sale apply.

Georg Fischer Piping Systems Ltd, Postfach, CH-8201 Schaffhausen/Switzerland

Phone +41 -(0)52-631 1111

e-mail: [info.ps@georgfischer.com](mailto:info.ps@georgfischer.com)

Internet: <http://www.gfps.com>